

TRADUR®

Supporting
elements



Balance

Supporting
elements

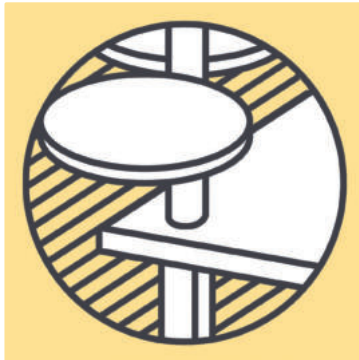

They provide support wherever a strong hold is needed! TRADUR® supporting feet, base levellers and consoles are just as much at home in contemporary single kitchens, country kitchens or designer loft kitchens.

The supporting feet, base levellers, supporting consoles and pillars only appear in the background as design elements. Yet, in modern interior design, they literally play a supporting role and create a balanced effect. In a highly variable and nuanced language of shapes and colours, stable and versatile in use!

TRADUR®

Supporting elements

Nuanced shapes – the variable sides of the TRADUR® range



TRADUR® Supporting feet
Classic, timeless and highly contemporary
Page 483–490

TRADUR® Base levellers
Ergonomic and flexible
Page 491–492

TRADUR® Consoles
Keep their promises
Page 493–506

TRADUR®

Supporting feet

Standard, classic
and modern



Standard	Page 485–486
Click rund	Page 486
Move 1	Page 487
Trampolo round	Page 487–488
Tonda Quadra	Page 488
Quadra	Page 488
Trampolo 2 square	Page 489
Kreta	Page 489
Rhodos	Page 489
Connero	Page 490

TRADUR®

Supporting feet

Colour meets shape –
the colourful side of the TRADUR® range



white glossy



chrome polished



stainless steel coloured



black matt pearly



stainless steel



chrome matt

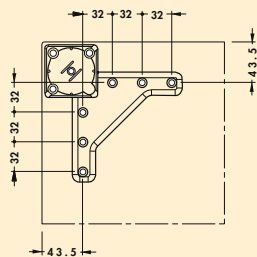

Trampolo 2 square

Supporting foot. Due to the sliding sleeve of -85 mm and +95 mm different heights can be achieved, may not be shortened.

- tube 60 x 60 mm
- load-bearing capacity ca. 150 kg

3011003	stainless steel coloured, H 620-800 mm	€ 133.40
3011007	stainless steel coloured, H 795-975 mm	€ 147.45
3011010	stainless steel coloured, H 1015-1195 mm	€ 184.31

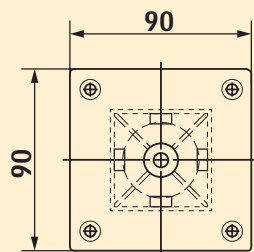

Kreta square foot aluminium

Supporting foot. Sturdy square aluminium profile. Suitable for attachment tables, but not for free standing tables, may not be shortened.

- tube 50 x 50 mm
- height (plus 10 mm height adjustment)
- load-bearing capacity ca. 150 kg

See catalogue 1 pages 498-499/26 EN for the matching consoles.

3013010	stainless steel coloured, H 700 mm	€ 110.68
3013012	stainless steel coloured, H 870 mm	€ 134.20
3013013	stainless steel coloured, H 1100 mm	€ 155.79
3013110	black matt, H 700 mm	€ 118.22
3013112	black matt, H 870 mm	€ 140.70
3013113	black matt, H 1100 mm	€ 164.22

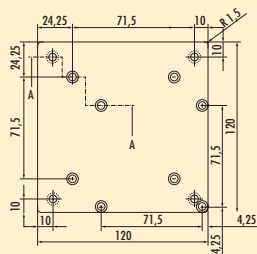

Rhodos square foot aluminium

Supporting foot. Stainless-steel coloured square foot for fastening to wood. The mounting plate for wood may be installed centrally as well as in a corner, may be shortened.

- tube 80 x 80 mm
- height (plus 15 mm height adjustment)
- incl. mounting plate for wood
- load-bearing capacity ca. 250 kg

See catalogue 1 pages 499-500/26 EN for the matching consoles.

3013025	stainless steel coloured, H 700 mm	€ 239.54
3013027	stainless steel coloured, H 870 mm	€ 271.70
3013028	stainless steel coloured, H 1070 mm	€ 295.53
3013029	stainless steel coloured, H 1100 mm	€ 302.74

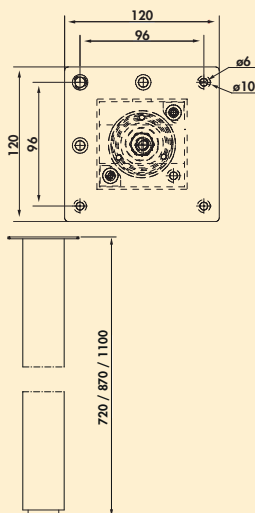

Connero 1

Supporting foot, square, may not be shortened.

- height plus 5 mm height adjustment
- tube 70 x 70 mm
- can be mounted flush to corner/centrally
- load-bearing capacity ca. 120 kg

See catalogue 1 pages 501–502/26 EN for the matching consoles.

3011105	black matt, H 720 mm	€ 142.02
3011106	black matt, H 870 mm	€ 173.95
3011107	black matt, H 1100 mm	€ 196.64

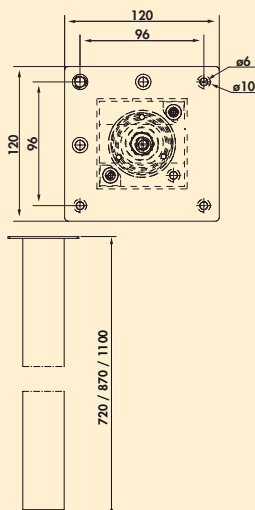

Connero 2



Supporting foot. Square, cannot be shortened.

- height plus 5 mm height adjustment
- tube 70 x 70 mm
- can be mounted flush with the corner or centrally
- with 2 integrated earthen plug sockets
- supply line 1900 mm, 3-core, free ends
- bearing capacity approx. 120 kg

See catalogue 1 pages 501–502/26 EN for the matching consoles.

3011108	black matt, H 720 mm	€ 290.76
3011109	black matt, H 870 mm	€ 303.95
3011110	black matt, H 1100 mm	€ 354.62

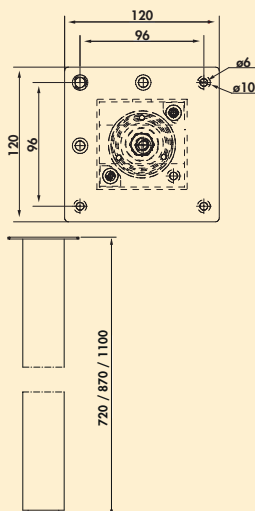

Connero 3



Supporting foot. Square, cannot be shortened.

- height plus 5 mm height adjustment
- tube 70 x 70 mm
- can be mounted flush with the corner or centrally
- with 1 integrated earthen plug socket and USB A/C charging function (USB A Quick Charge 3.0/USB C Power Delivery 3.0)
- supply line 1900 mm, 3-core, free ends
- bearing capacity approx. 150 kg

See catalogue 1 pages 501–502/26 EN for the matching consoles.

3011111	black matt, H 720 mm	€ 445.38
3011112	black matt, H 870 mm	€ 457.98
3011113	black matt, H 1100 mm	€ 508.40

TRADUR®

Base levellers

Standard, classic
and modern



■ Cippo
Kreta
Cosa

Page 492

Page 492

Page 492

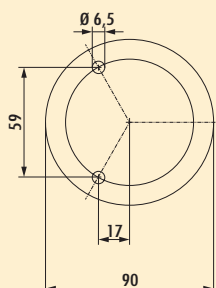

Cippo



Base leveller. With washer, may be shortened. Suitable for supporting foot Colonna.

- tube-Ø 45 mm
- 10 mm height adjustment
- load-bearing capacity ca. 200 kg

3013040 stainless steel, H 145 mm € 120.06

3013041 stainless steel, H 195 mm € 122.00



Kreta

Aluminium base leveller as alternative to aluminium frames, stainless-steel coloured anodized. Flexible and versatile in use.

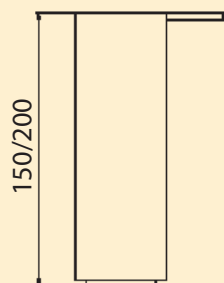

Kreta

Base leveller. Aluminium, may not be shortened.

- tube 50 x 50 mm
- 10 mm height adjustment
- load-bearing capacity ca. 150 kg

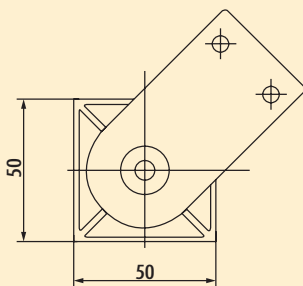

3013064 stainless steel coloured, H 150 mm € 53.54

3013065 stainless steel coloured, H 200 mm € 58.19

3013164 black matt, H 150 mm € 56.17

3013165 black matt, H 200 mm € 61.27



Cosa 2

Base leveller, may not be shortened.

- tube Ø 50 mm
- 30 mm height adjustment
- load-bearing capacity ca. 150 kg

3013047 chrome polished, H 150 mm € 22.82

3013048 stainless steel coloured, H 150 mm € 26.51

TRADUR® Consoles

Keep their promises



■ Korfu	Page 494–495
Capitello	Page 495–496
Typ 41, 40, 42	Page 497
Glass adapter disk	Page 498
Kreta	Page 498–499
Rhodos	Page 499–500
Angle bracket Siena	Page 501
Connero	Page 501–502
Typ 50, 51, 45	Page 502–503
Console rigid	Page 503
Folding console	Page 503
Vettore folding console	Page 504
Spruzzo	Page 505
Glass shelf	Page 505

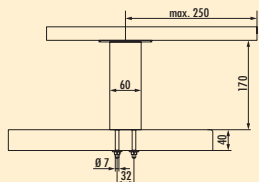

Korfu 1

- Console.
 – straight
 – elegant design 60 x 10 mm
 – max. load per pair approx. 60 kg given even distribution, max. spacing of the consoles of 900 mm and max. projection of the plates of 250 mm

Suitable for base frame (see catalogue 3, p. 83–85/26 EN).

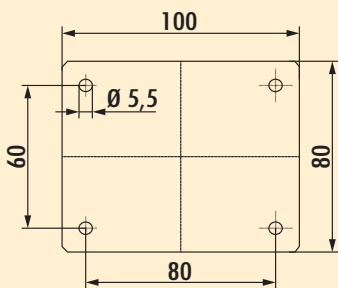

3021177 stainless steel coloured, H 170 mm

€ 59.42

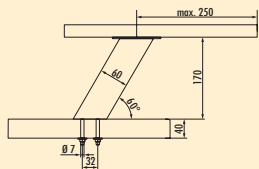

Korfu 2

- Console.
 – slanted
 – elegant design 60 x 10 mm
 – max. load per pair approx. 60 kg given even distribution, max. spacing of the consoles of 900 mm and max. projection of the plates of 250 mm

Suitable for base frame (see catalogue 3, p. 83–85/26 EN).

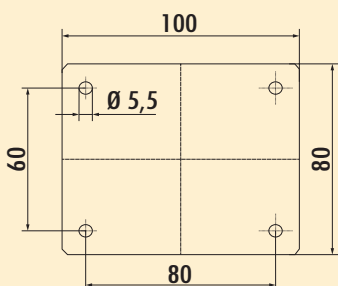

3021178 stainless steel coloured, H 170 mm

€ 60.74

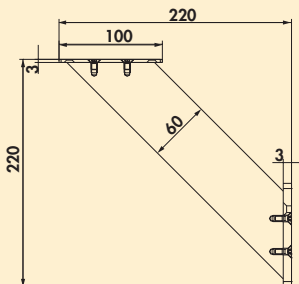
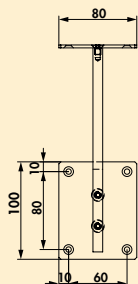

Korf 3

Console.
 – slanted
 – elegant design 60 x 10 mm
 – max. load per pair approx. 60 kg given even distribution, max. spacing of the consoles of 900 mm and max. projection of the plates of 250 mm

Suitable for base frame (see catalogue 3, p. 83–85/26 EN).

3021191 stainless steel coloured, H 220 mm € 76.62

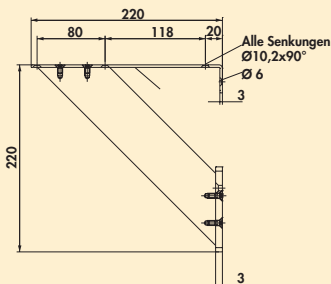
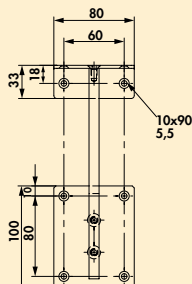

Korf 4

Console. With mounting plate.
 – slanted
 – elegant design 60 x 10 mm
 – max. load per pair approx. 60 kg given even distribution, max. spacing of the consoles of 900 mm and max. projection of the plates of 250 mm

Suitable for base frame (see catalogue 3, p. 83–85/26 EN).

3021192 stainless steel coloured, H 220 mm € 88.73

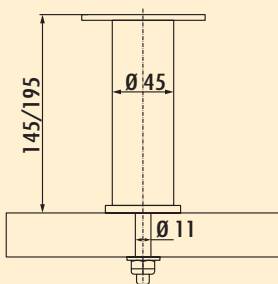
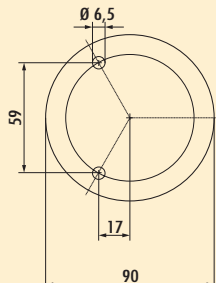

Capitello 1

Console with washer and bolted connection. Suitable for base leveller Cippo (see catalogue 1 pages 492/26 EN).
 – max. load per pair approx. 60 kg given even distribution, max. spacing of the consoles of 900 mm and max. projection of the plates of 250 mm

When using the glass adapter disk (3021056) bonding should be performed by a glazier.

3013042 stainless steel, H 145 mm, tube Ø 45 mm € 127.61

3013043 stainless steel, H 195 mm, tube Ø 45 mm € 129.45

Optional accessories

3021056 Glass adapter disk, stainless steel, Ø 90 mm € 54.50

Supporting elements

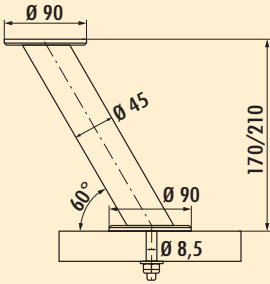
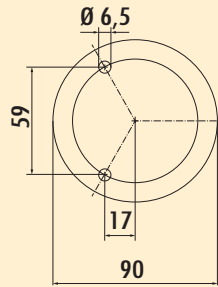

Capitello 2



Console. With bolted connection.

- slanted
- max. load per pair approx. 40 kg given even distribution, max. spacing of the consoles of 900 mm and max. projection of the plates of 250 mm

When using the glass adapter disk (3021056) bonding should be performed by a glazier.

3021072	chrome polished, H 170 mm, tube Ø 45 mm	€ 107.87
3021073	chrome polished, H 210 mm, tube Ø 45 mm	€ 116.38
3021075	stainless steel, H 170 mm, tube Ø 45 mm	€ 134.20
3021076	stainless steel, H 210 mm, tube Ø 45 mm	€ 136.04

Optional accessories

3021056	Glass adapter disk, stainless steel, Ø 90 mm	€ 54.50
---------	--	---------

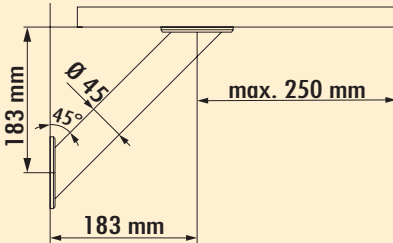
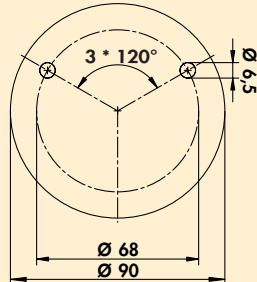

Capitello 3



Console.

- slanted
- max. load per pair approx. 40 kg given even distribution, max. spacing of the consoles of 900 mm and max. projection of the plates of 250 mm

When using the glass adapter disk (3021056) bonding should be performed by a glazier.

3021074	stainless steel, H 183 mm, tube Ø 45 mm	€ 146.39
---------	---	----------

Optional accessories

3021056	Glass adapter disk, stainless steel, Ø 90 mm	€ 54.50
---------	--	---------

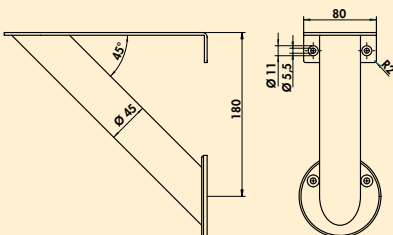
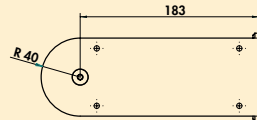

Capitello 4



Console. With mounting plate.

- slanted
- max. load per pair approx. 60 kg given even distribution, max. spacing of the consoles of 900 mm and max. projection of the plates of 250 mm

3021089	stainless steel, H 180 mm, tube Ø 45 mm	€ 115.41
---------	---	----------

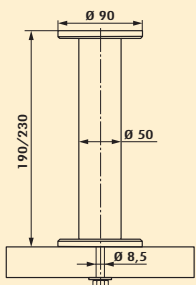
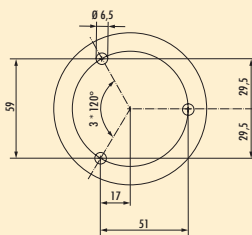

Model 41



Console. With bolted connection.

— max. load per pair approx. 60 kg given even distribution, max. spacing of the consoles of 900 mm and max. projection of the plates of 250 mm

When using the glass adapter disk (3021056) bonding should be performed by a glazier.

3021063 stainless steel, H 190 mm, tube Ø 50 mm € 146.39

3021066 stainless steel, H 230 mm, tube Ø 50 mm € 164.22

Optional accessories

3021056 Glass adapter disk, stainless steel, Ø 90 mm € 54.50

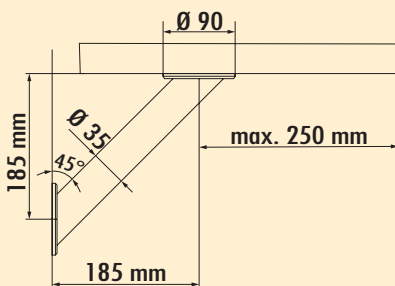
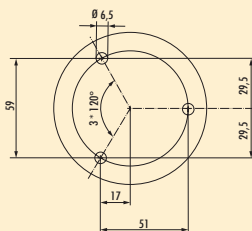

Model 40



Console.

— max. load per pair approx. 40 kg given even distribution, max. spacing of the consoles of 900 mm and max. projection of the plates of 250 mm

When using the glass adapter disk (3021056) bonding should be carried out by a glazier.

3021097 stainless steel, H 185 mm, tube Ø 35 mm € 148.24

Optional accessories

3021056 Glass adapter disk, stainless steel, Ø 90 mm € 54.50

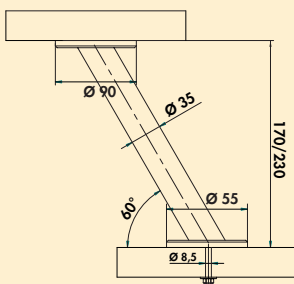
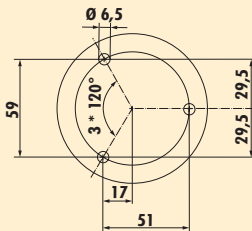

Model 42



Console. With bolted connection.

— slanted

— max. load per pair approx. 60 kg given even distribution, max. spacing of the consoles of 900 mm and max. projection of the plates of 250 mm

For granite tops, the Capitello series is better.

When using the glass adapter disk (3021056) bonding should be performed by a glazier.

3021083 stainless steel, H 170 mm, tube Ø 35 mm € 159.48

3021084 stainless steel, H 230 mm, tube Ø 35 mm € 164.22

Optional accessories

3021056 Glass adapter disk, stainless steel, Ø 90 mm € 54.50

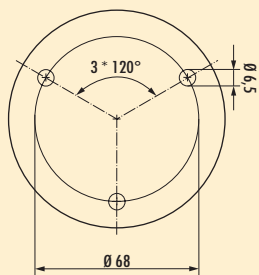

Glass adapter disk



Optimal accessories for Colonna, Capitello 1, 2, 3, Turn Around and Model 40, 41, 42.

- height 12 mm
- to be bolted from below

Gluing should be performed by a glazier.

3021056 stainless steel, Ø 90 mm

€ 54.50

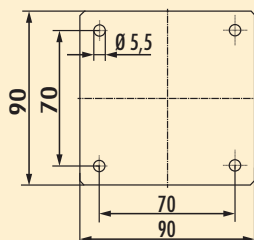

Kreta 1 slanted

Console.

- slanted
- aluminium profile 50 x 50 mm, milled
- slant angle 60°
- max. load per pair approx. 60 kg given even distribution, max. spacing of the consoles of 900 mm and max. projection of the plates of 250 mm

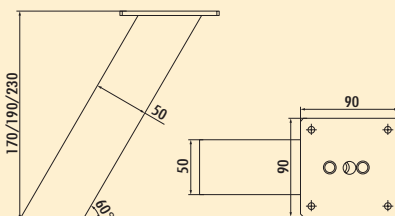

3023028 stainless steel coloured, H 170 mm

€ 116.38

3023022 stainless steel coloured, H 190 mm

€ 118.22

3023023 stainless steel coloured, H 230 mm

€ 123.84

3023030 black matt, H 170 mm

€ 114.45

3023031 black matt, H 190 mm

€ 116.38

3023032 black matt, H 230 mm

€ 122.00



Kreta 2 straight

Console. Aluminium profile 50 x 50 mm.

- straight
- max. load per pair approx. 60 kg given even distribution, max. spacing of the consoles of 900 mm and max. projection of the plates of 250 mm

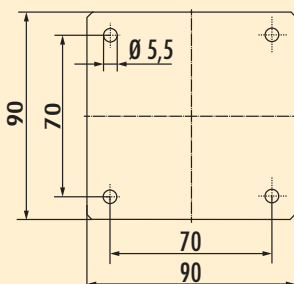

3023029 stainless steel coloured, H 170 mm

€ 48.18

3023026 stainless steel coloured, H 190 mm

€ 51.26

3023027 stainless steel coloured, H 230 mm

€ 56.17

3023033 black matt, H 170 mm

€ 47.57

3023034 black matt, H 190 mm

€ 50.55

3023035 black matt, H 230 mm

€ 55.39

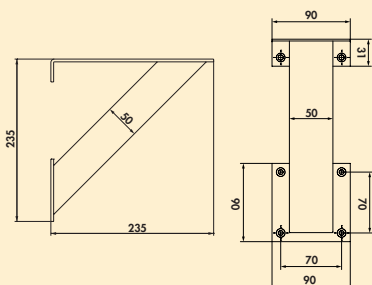

Kreta 3 slanted

Console. With mounting plat.

- slanted
- aluminium profile 50 x 50 mm, milled
- max. load per pair approx. 60 kg given even distribution, max. spacing of the consoles of 900 mm and max. projection of the plates of 250 mm

3021190	stainless steel coloured, H 235 mm	€ 110.68
3021193	black matt, H 235 mm	€ 127.61

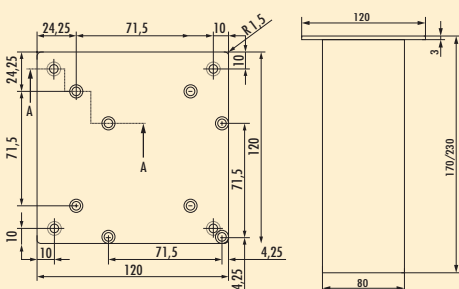

Rhodos 1

Console.

- aluminium profile 80 x 80 mm
- max. load per pair approx. 60 kg given even distribution, max. spacing of the consoles of 900 mm and max. projection of the plates of 250 mm

3023046	stainless steel coloured, H 170 mm	€ 152.02
3023044	stainless steel coloured, H 230 mm	€ 156.67
3023062	black matt, H 170 mm	€ 165.55
3023063	black matt, H 230 mm	€ 173.11

Supporting elements

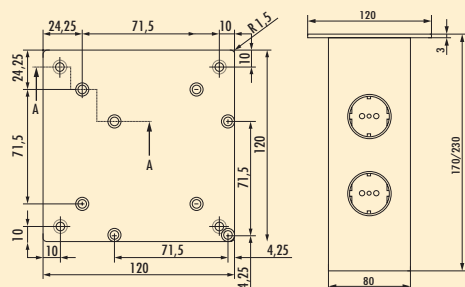

Rhodos 2



Console.

- aluminium profile 80 x 80 mm
- with **one or two** integrated earthing contact sockets
- supply line 1500 mm, 3-wire, free ends
- connection through the worktop
- max. load per pair approx. 60 kg given even distribution, max. spacing of the consoles of 900 mm and max. projection of the plates of 250 mm

3023047 stainless steel coloured, H 170 mm, 1 socket € 270.23

3023045 stainless steel coloured, H 230 mm, 2 sockets € 278.67

3023064 black matt, H 170 mm, 1 socket € 278.99

3023065 black matt, H 230 mm, 2 sockets € 313.45

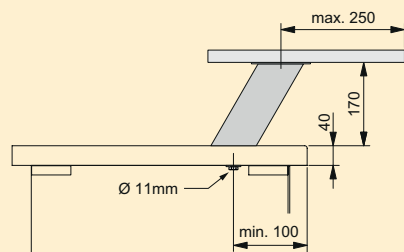

Rhodos 3

Console.

- slanted
- aluminium profile 80 x 80 mm
- max. load per pair approx. 60 kg given even distribution, max. spacing of the consoles of 900 mm and max. projection of the plates of 250 mm

3023040 stainless steel coloured, H 170 mm € 164.22

3023060 black matt, H 170 mm € 176.29

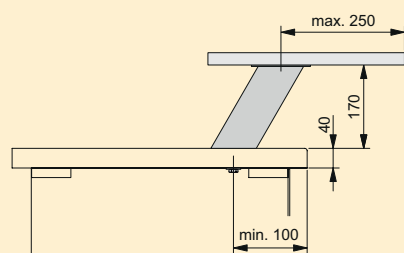

Rhodos 4



Console.

- slanted
- aluminium profile 80 x 80 mm
- with **one** integrated earthing contact socket
- supply line 1500 mm, 3-wire, free ends
- connection through the worktop
- max. load per pair approx. 60 kg given even distribution, max. spacing of the consoles of 900 mm and max. projection of the plates of 250 mm

3023041 stainless steel coloured, H 170 mm € 278.67

3023061 black matt, H 170 mm € 295.15

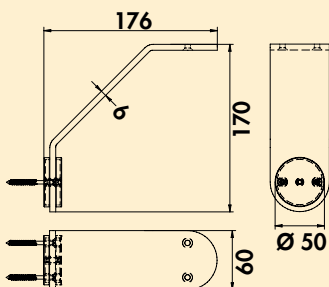

Angle bracket Siena

For side mounting on the body or wall and for stabilisation of corner joints. With an elegant round cover plate for concealed installation.

- powder-coated steel
- 170 x 170 x 60 mm (H x W x D)
- material thickness 6 mm
- angle 45°
- **bearing capacity 30 kg/bracket**

3033187 black matt, price per pc.

€ 122.83



Connero

The Connero console series combines impressive design with new and highly practical features. The variants of the stylish support elements are equipped with technical features and can be used as a power source and charging station for mobile devices. A pair of consoles guarantees a load capacity of 60 kilograms and can be combined to provide multiple sockets along with high-performance USB A 3.0 plus USB C 3.0 ports. Thanks to the slanted design of the Connero consoles, the raised counter area can be arranged in an especially striking and convenient manner.

Supporting elements

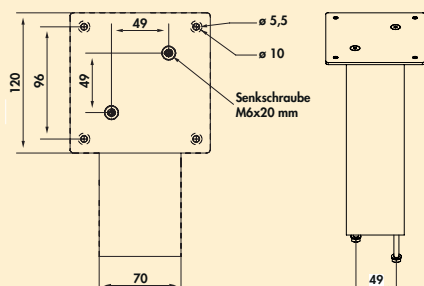

Connero 1 slanted

Console. With mounting plat.

- slanted
- aluminium profile 70 x 70 mm
- max. load per pair approx. 60 kg given even distribution, max. spacing of the consoles of 900 mm and max. projection of the plates of 250 mm

3021194 black matt, H 170 mm

€ 100.84

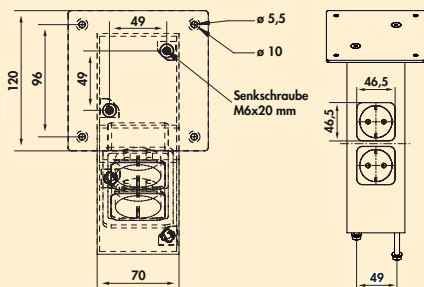

Connero 2 slanted



Console. With mounting plat.

- slanted
- aluminium profile 70 x 70 mm
- **with 2 integrated earthing contact sockets**
- supply line 1500 mm, 3-wire, free ends
- connection through the worktop
- max. load per pair approx. 60 kg given even distribution, max. spacing of the consoles of 900 mm and max. projection of the plates of 250 mm

3021195 black matt, H 170 mm

€ 217.65

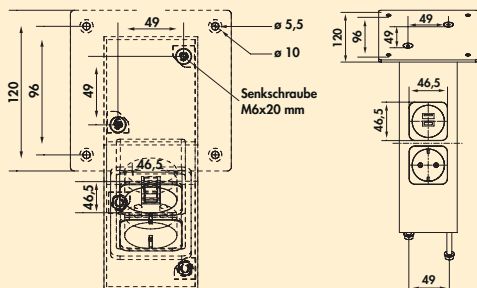

Connero 3 slanted



Console. With mounting plat.

- slanted
- aluminium profile 70 x 70 mm
- **with 1 integrated earthed plug socket and USB A/C charging function (USB A Quick Charge 3.0/USB C Power Delivery 3.0)**
- supply line 1500 mm, 3-wire, free ends
- connection through the worktop
- max. load per pair approx. 60 kg given even distribution, max. spacing of the consoles of 900 mm and max. projection of the plates of 250 mm

3021196 black matt, H 170 mm

€ 372.27

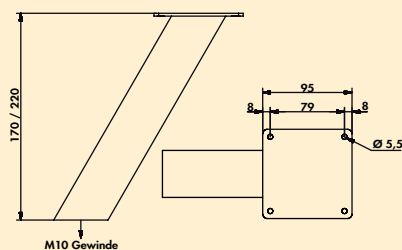

Model 50

Console.

- slanted
- aluminium profile 50 x 50 mm
- max. load per pair approx. 30 kg given even distribution, max. spacing of the consoles of 900 mm and max. projection of the plates of 250 mm

3021184 stainless steel coloured, H 170 mm

€ 59.50

3021186 stainless steel coloured, H 220 mm

€ 62.84

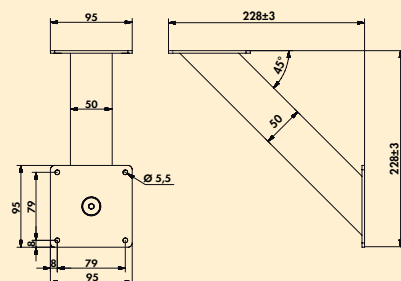

Model 51

Console. For fastening to cabinet body.

- slanted
- aluminium profile 50 x 50 mm
- max. load per pair approx. 30 kg given even distribution, max. spacing of the consoles of 900 mm and max. projection of the plates of 250 mm

3021181 stainless steel coloured, H 228 mm

€ 89.18

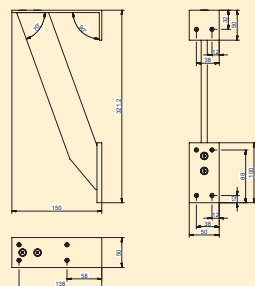

Model 45

Console. For fastening to cabinet body.

- aluminium profile 50 x 10 mm
- max. load per pair approx. 30 kg given even distribution, max. spacing of the consoles of 900 mm and max. projection of the plates of 250 mm

3021082 aluminium anodised, H 321.2 mm

€ 74.51

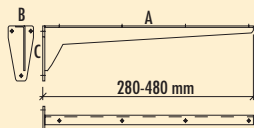

Console rigid

Sturdy sheet-metal construction. Shelf support with welded mounting plate.

- primed in grey
- load-bearing capacity ca. 75 kg

3021085 A 280, W 53, C 100 mm

€ 36.85

3021086 A 330, W 53, C 100 mm

€ 39.85

3021087 A 380, W 65, C 130 mm

€ 53.36

3021088 A 480, W 65, C 130 mm

€ 56.70

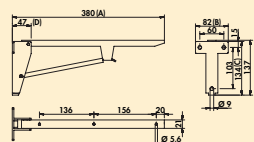

Folding console

Robust steel construction. When opened, the folding console automatically engages and may be disengaged just as easily by lifting the locking arm.

- primed in grey
- load-bearing capacity ca. 75 kg

3021093 A 380, W 82, C 134, D 50 mm

€ 115.85

3021094 A 480, W 82, C 152, D 50 mm

€ 126.39

3021095 A 580, W 82, C 178, D 50 mm

€ 143.05

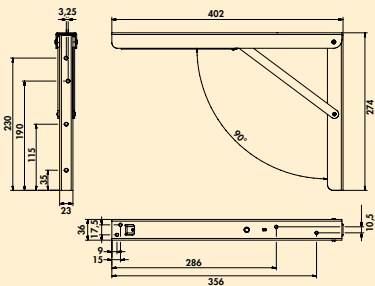
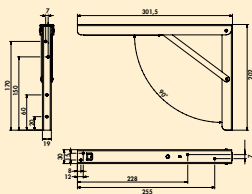

Vettore folding console

- galvanised
- drill Ø 4 mm
- can be locked in three positions, 90°, 80°, 70°
- four fixing points each to the wall and countertop
- load bearing capacity approx. 100 kg
- 1 PU = 1 skid

3021053	300 x 200 x 30 mm, price per PU	€ 60.29
3021055	400 x 270 x 36 mm, price per PU	€ 75.84

Supporting elements



Spruzzo

Splash protection for fastening to the worktop. The bolted connection is fastened underneath the worktop. May be used for stove tops and sinks, also in gastronomy and shop construction. May also be used as a screen.

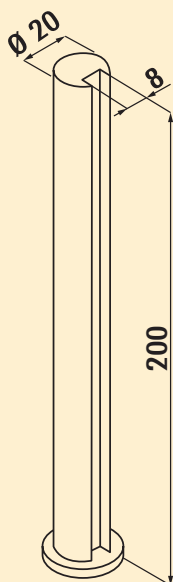

Spruzzo

Console. Splash protection. Suitable for 8 mm glass plate thickness.

- drill Ø 6 mm
- glass shelves to be ordered separately

3021132	stainless steel coloured, H 200 mm, Ø 20 mm, price per pair	€ 78.55
3021134	black matt, H 200 mm, Ø 20 mm, price per pair	€ 78.55



Glass shelf

Optional accessories for Spruzzo (3021132, 3021134), Kaiman (3021078, 3021092), Prior (3021032, 3021035), Akro (3021009) and Moon (3021090, 3021091).

- high-quality glass plates with polished edges
- thickness 8 mm
- depth 200 mm

3021014	clear glass, L 580 mm	€ 47.75
3021026	clear glass, L 880 mm	€ 70.13
3021124	clear glass, L 1140 mm	€ 77.50
3021114	satinised glass, L 580 mm	€ 72.94
3021126	satinised glass, L 880 mm	€ 103.31
3021125	satinised glass, L 1140 mm	€ 118.65

Supporting
elements